

## Modular PCB Terminal Block ▶ 742 Series

Disconnect/test block ▶ CAGE CLAMP® ▶ Actuation type: Operating tool ▶ 2.5 mm<sup>2</sup> ▶ Pin spacing: 5 mm (0.197 inch) ▶ Color: gray

Conductor entry angle to the PCB: 60° ▶ Number of connection points: 1

Conductor entry angle to the PCB: 90° ▶ Number of connection points: 2

Conductor entry angle to the PCB: 90° ▶ Number of connection points: 3

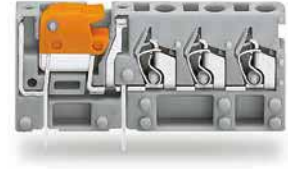
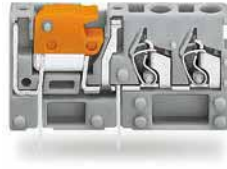

| Color  | Item No. | PU (SPU) |
|--------|----------|----------|
| ● gray | 742-101  | 384 (96) |

| Color  | Item No. | PU  |
|--------|----------|-----|
| ● gray | 742-151  | 200 |

| Color  | Item No. | PU  |
|--------|----------|-----|
| ● gray | 742-153  | 100 |

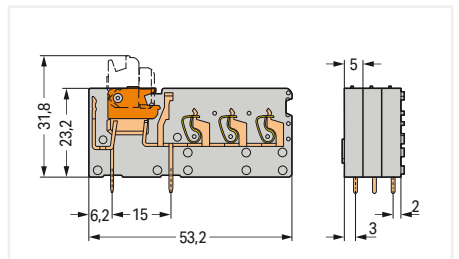
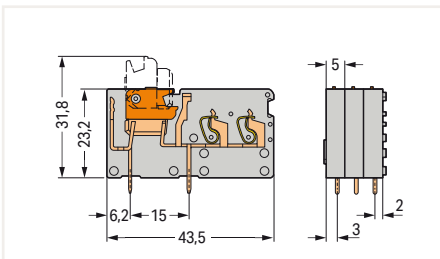
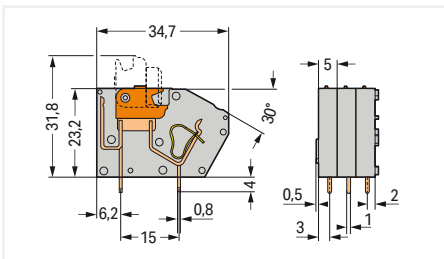

Item-Specific Accessories

Item-Specific Accessories

Item-Specific Accessories



End plate; 1.5 mm; snap-on type

| Color  | Item No. | PU (SPU)  |
|--------|----------|-----------|
| ● gray | 742-100  | 300 (100) |

End plate; 1.5 mm; snap-on type

| Color  | Item No. | PU (SPU)  |
|--------|----------|-----------|
| ● gray | 742-150  | 300 (100) |

End plate; 1.5 mm; snap-on type

| Color  | Item No. | PU (SPU)  |
|--------|----------|-----------|
| ● gray | 742-152  | 300 (100) |

PU = Packaging Unit; SPU = Subpackaging Unit; Dimensions in mm